

FALCON FORCE



424-Men ACCOMMODATION CRANE WORK BARGE

The "FALCON FORCE" is an Accommodation Crane/Workbarge purpose-built to the high safety standards in accordance to IMO 'MODU CODE' Resolution A414 Chapter XI. She is designed for unrestricted service and has extensive experience in performing and fulfilling the following duties:

- Hydraulic Workover/ Well Stimulation and Coiled Tubing Services
- Deep Water Mooring Well Intervention
- Offshore Conductor Piling/ Platform Construction Support
- Offshore Platform maintenance
- Offshore Hook-Up and Commissioning
- Subsea and Dive Support Services
- Accommodation/ Floatel Services
- Designed ready for Pipelay services
- Upgradable to 500-Men Accommodation

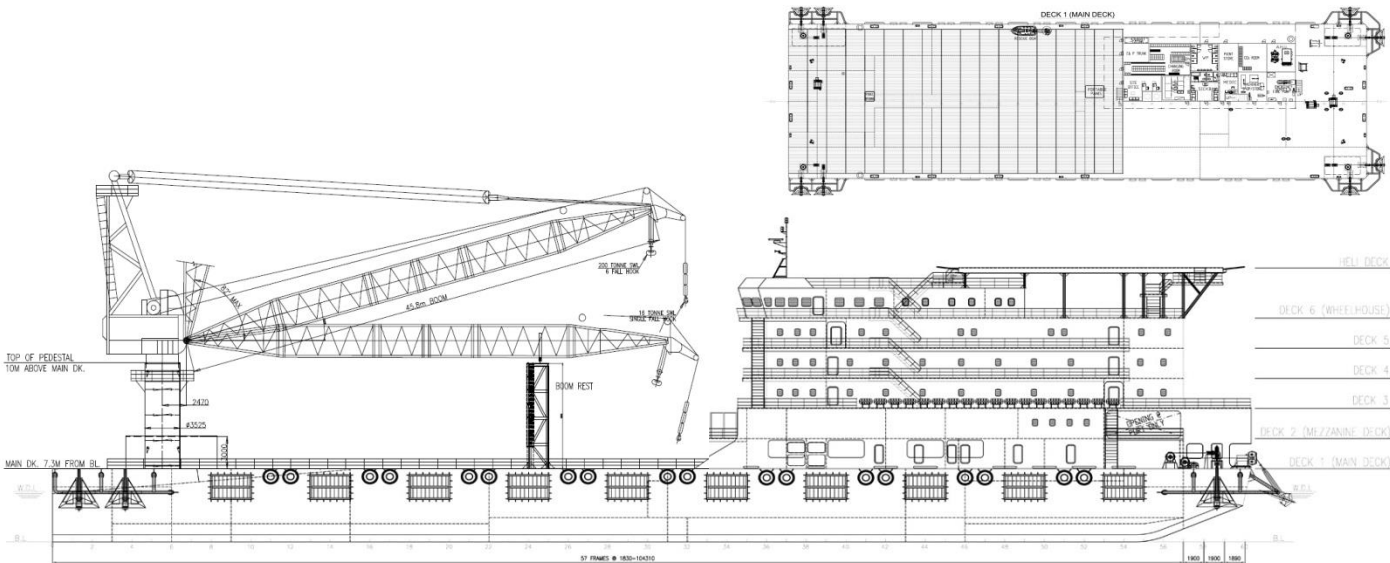
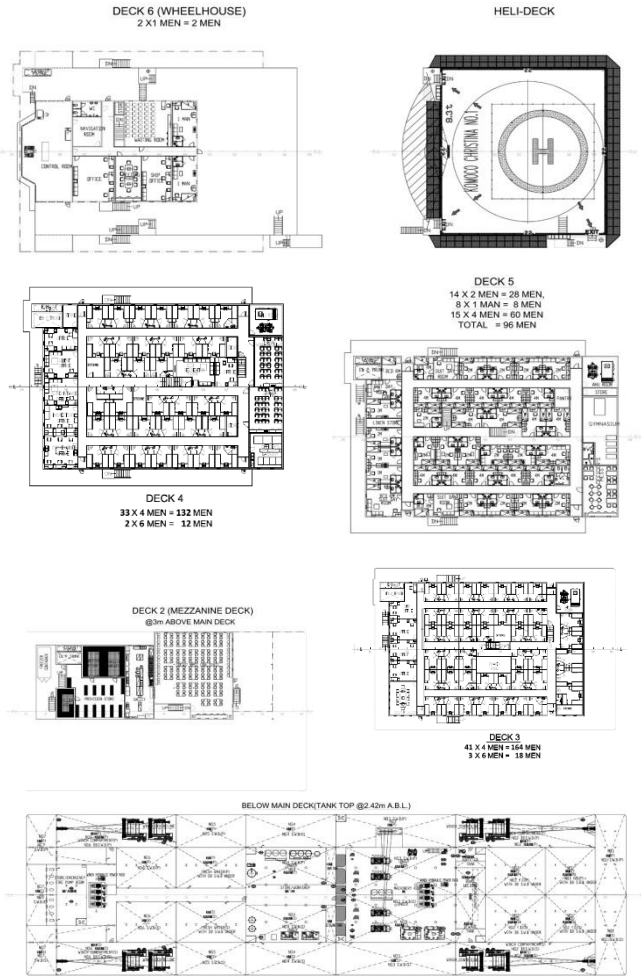

STANDARD VESSEL SPECIFICATIONS

GENERAL PARTICULARS

Owner	PT. Bayu Maritim Berkah
Classification & Society	ABS *A1 Accommodation and Work Barge + BKI (dual class)
Year Built	2009
Flag State	Indonesia
Port of Registry	Jakarta

PRINCIPLE DIMENSIONS

L.O.A. (m)	110.57
Length B.P. (m)	106.15
Breadth (m)	31.70
Depth (m)	7.30
Min. Draft (m)	3.60
Extreme Draft (m)	5.08
Deadweight	11,355.69 MT
Displacement (max)	17,373.18 MT
Cargo Deck Area (m ²)	2,250
Deck Strength	15 T/m ²
Deck Cargo	6,584.9 MT
Cargo Pumps	130 m ³ /h @60m head
Boat Landings (Port & Starboard)	7m x 1.5m width

ACCOMMODATION

Number of Berth	424 Men
Cabins Layout	10 x 1 man = 10 14 x 2 men = 28 89 x 4 men = 356 5 x 6 men = 30 Total 118 cabins = 424 Men
1 x Galley	1 x Central Control Room
2 x Messroom	1 x 3 Bed Hospital
13 x Offices	2 x Conference Room
2 x Cinema Room	1 x Gymnasium
1 x Recreation Room	1 x Prayer Room
1 x Radio Room	

STORAGE CAPACITIES

Fuel Oil Capacity	1,500 m ³
Fresh Water	1,400 m ³

* All particulars believed to be correct but without guarantees

PT. BAYU MARITIM BERKAH

Jl. Tambak No. 21A-B
Pegangsaan, Menteng
Jakarta Pusat 10320 - Indonesia

Telephone : +62 21 31920123 (Hunting)
Fax : +62 21 3914903
Email : marketing@bayumaritim.com
Website : www.bayumaritim.com

COMMUNICATION

Radar	1 x RayMarine C120 Radar
Radios VHF	2 x Samyung STR 600A 183 Channels
Echo Sounder	One (1) unit (Samyung)
Weather Data	1 x Navtex (Samyung)
G.P.S.	Yes (Samyung)
Radios HF	1 x Samyung SRG1150DN MF/HF Radio
Handheld Walkie Talkie	6 x Motorola GP328 VHF/Walkie Talkie,
VHF/AM Aero-Transmitter	One (1) unit (ICOM)
Control Station	Yes, Central Control Room with full view of the entire working deck
P.A. Systems	Yes, Throughout The Barge
AIS	One (1) unit (Samyung)
Inmarsat System Satellite Comms	One (1) Inmarsat-C One (1) Mini-M, Thrane & Thrane

MOORING SYSTEM

Mooring Wince/Type/no.	Single drum type, (8 units)
Wire Size/length	52mm x 1,500M, 6 X 25 IWRC flexible steel wire (8 + 1 spare coil)
Anchor + Buoy	8 x 10 tons Flipper Delta Anchors + 1 spare 8 T Flipper Delta Anchor & foam filled buoys c/w pendant wire
Tension Meter + CCTV	Tension meter & closed circuit TV monitors are installed
Anchor Rack	Fitted at four (4) corners of the barge for 8-point mooring

OFFSHORE CRANE

Main Crane	'FAVELLE FAVCO' PC 200 40/10K – API SPEC 2C
Capacity	200 metric tonnes @ 30 feet radius at an elevation of 175 feet
Crane Pedestal	10 meter above main deck
Crane Boom	150 feet Boom
Max. Height Elevation	187 feet (57M) above main sea level
Aux Crane	BLM 50 T SWL, 30m boom length

AUXILIARY EQUIPMENT

Generators	4 x CAT 3412 DITA Diesel Generators 500kw, 50Hz each
Lifejackets	740 pieces DOT approved (200%)
Liferafts	30 x 25 men total 740 men capacity
Rescue boat	1 x FRC c/w launching davit
Fire Fighting Equipment	2 x 160m ³ /hr Fire Pump, 4 x Fire Monitor, Engine Room & Paint Store Extinguishing System – CO2 system full coverage
Water Sprinkler System	Available
Fresh Water Maker	2 x "REVERSE OSMOSIS" 80 tons/24 hr each (Total 160 tons/day)

HELIDECK

Dimension Standard	22.00 m x 22.00 m for Sikorsky 'S91N' In compliance to Classification & CAP 437
Helicopter	SIKORSKY 'S91N'

